

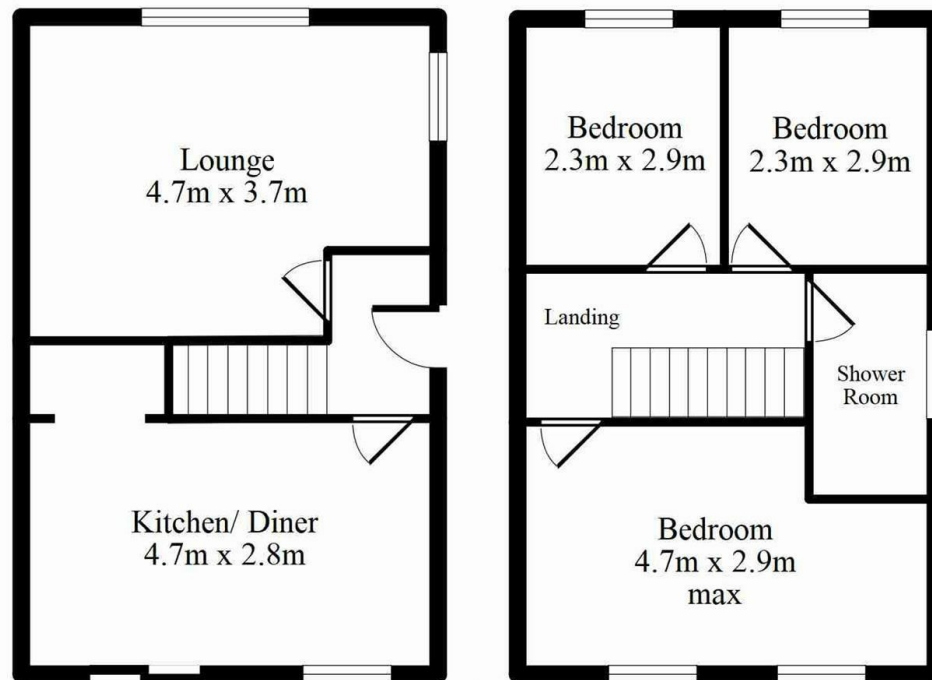

21 Herbert Street, Clayton, Bradford, BD14 6LD

£210,000

- THREE BEDROOM SEMI DETACHED
- OPEN OUTLOOK TO THE REAR
- GAS CH & UPVC DG
- EARLY VIEWING ADVISED
- WELL PRESENTED
- DRIVEWAY & GARAGE
- DECKED PATIO WITH PERGOLA
- PRIVATE LOCATION
- GARDENS TO THREE SIDES
- POPULAR LOCATION



Every attempt has been made to ensure this floor plan is accurate, however their accuracy is not guaranteed. The floorplan is for illustrative purposes and should be used in that context. GFPMs 2025

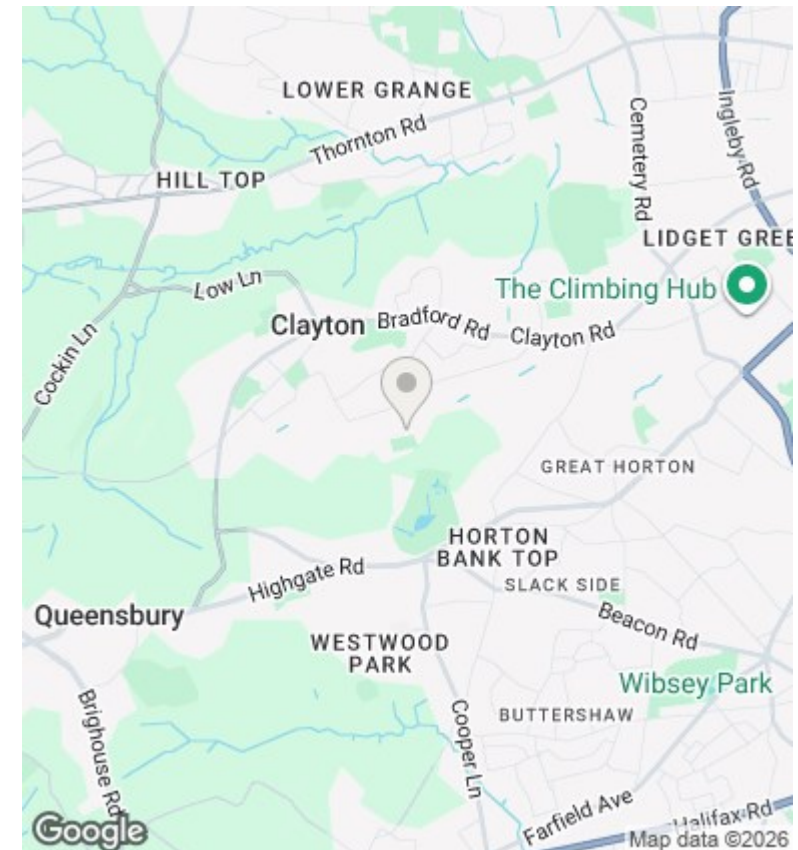

Directions

Viewings

Viewings by arrangement only.
Call 01274884040 to make an appointment.

Council Tax Band

EPC Rating:

Energy Efficiency Rating		
	Current	Potential
Very energy efficient - lower running costs		
(92 plus) A		
(81-91) B		
(69-80) C		
(55-68) D		
(39-54) E		
(21-38) F		
(1-20) G		
Not energy efficient - higher running costs		
England & Wales	EU Directive 2002/91/EC	